

## AIR PURIFIER D.PURE-AIR 25



Sistemi per la climatizzazione

## SAFETY WARNINGS

When using the unit, please observe the following safety precautions:

- This appliance can be used by children aged from 8 years and above and persons with reduced physical, sensory or mental capabilities or lack of experience and knowledge if they have been given supervision or instruction concerning use of the appliance in a safe way and understand the hazards involved. Children shall not play with the appliance. Cleaning and user maintenance shall not be made by children without supervision.
- Unplug the power supply cord before cleaning or maintenance.
- Keep all packaging ( plastic bags, foam , screws) out of the reach of children or persons with reduced physical or mental capabilities , as this could compromise their safety
- Do not submerge the unit in water, or place the unit close to water.
- Don't use the unit near bath-tubs, basins, showers. Never use the appliance outside.
- Don't use any extension cable to power the unit.
- Don't install the unit upon unstable or not plane surfaces
- Don't cover the product.
- Don't use the product with wet hands,
- Do not submerge the unit in water, or place the unit close to water.
- Do not put the unit close to heat-generating devices or near flammable and dangerous materials.
- Never put your fingers or objects into the intake or discharge ducts.
- Do not sit or stand on the unit.
- Discharge water that has collected in the tank as required
- If the power supply cord is damaged it must be replaced by the manufacture or a qualified service agent.
- Do not put the unit close to heat-generating devices or near flammable and dangerous materials.
- Never put your fingers or objects into the intake or discharge ducts.
- Do not sit or stand on the unit.
- Don't switch the unit on or off, inserting or pulling the power cable.
- Don't put any objects on the unit
- Don't jump or stay upon the appliance.

- Don't clean the appliance, if it has not been switched off, disconnected the power cable or powered off the dedicated switch.
- If some burning smell or smoke is coming out from the unit, immediately power off the unit from the supply, open the window and call the Service Center or qualified technician.
- Assure adequate air change in the room where the unit is installed, if any gas combusting appliances.
- If the power cable is damaged, it must be replaced by the producer, or the authorized service center or anyhow by qualified electricians.
- Don't use sprays, insect killer products or any solvents for cleaning the appliance.
- This appliance has been designed as domestic air purifier. Don't use the appliance for different purposes
- Never use the appliance outside.
- Don't use any extension cable to power the unit.
- Don't install the unit upon unstable or not plane surfaces.
- Don't operate in environments where are present flammable or explosive materials and substances, or where corrosive and dangerous vapors and substances are present.
- Don't enter water in the upper grille. Don't obstruct the air flow.
- Before removing the appliance, be sure that the water tank is empty
- Never damage, modify, heat up the power cable. Never put heavy or sharp objects on it. Keep the power cord far from source of heat.
- If the power supply cord is damaged it must be replaced by the manufacturer or a qualified service agent.
- The appliance must be positioned so that the plug is accessible.
- Please keep a distance 30 cm around unit and the wall or other objects to ensure correct operation .
- The appliance shall be installed in accordance with local national wire regulations.
- The appliance is for indoor use only.
- This appliance is not intended for use by persons with reduced physical sensory or mental Capabilities ,or lack of experience and knowledge, unless they have been given supervision or instruction concerning use of the appliance by a person responsible for their safety.

- Children should be supervised to ensure that they do not play with the appliance.
- Don't repair the product by yourself. Any problem, please contact professional service for help.
- The appliance shall not be installed in the laundry.
- Appliances that are obviously damaged must not be operated.
- Do not place heavy objects on the cables or heat sources close to them . The cables may be damaged;
- Before carrying out any cleaning or maintenance, disconnect the appliance from the mains by removing the plug;
- Do not use aerosols sprays (eg . insecticides , hair spray , etc. ), it may cause damage to the housing;
- In case of abnormal situations immediately turn off the power and contact your dealer or service center
- Do not use this unit connected to programmers, external timer , remote control system of separate timer or any other device that can switch automatically;
- Do not use power sockets flying or damaged cables;
- Don't pull the power cable to move the product or to disconnect it from main supply.

## Preparation

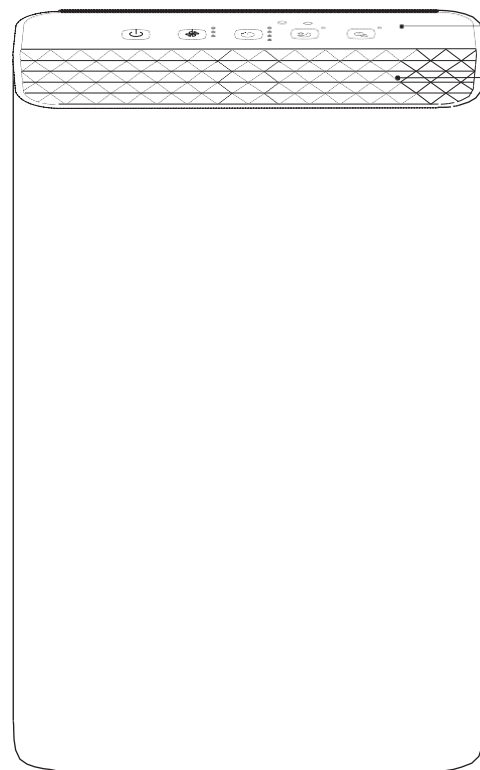

control panel  
air outlet

front

handle

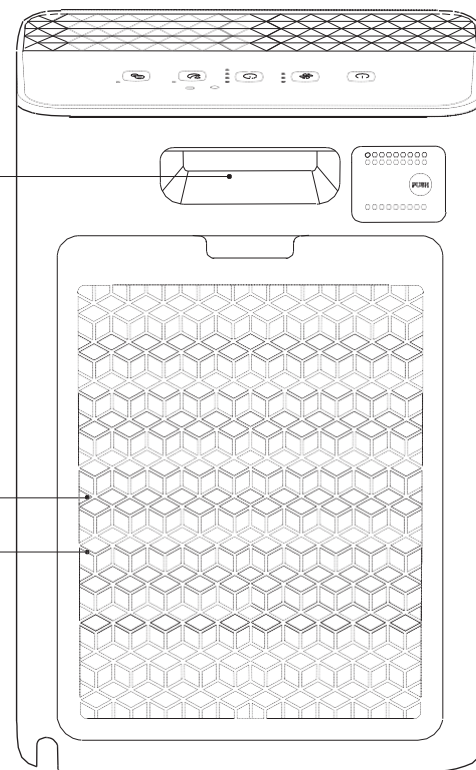

air inlet  
back cover

rear

## Installation

### 1 Install filter components

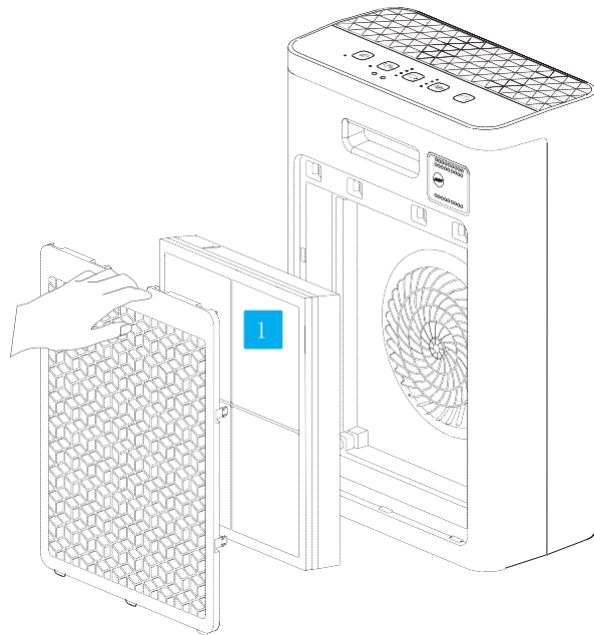

Remove the filter components



Remove the packaging bags of filter components.



Install the filter components

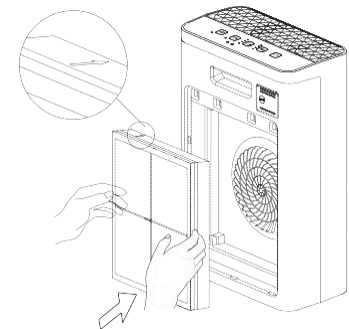
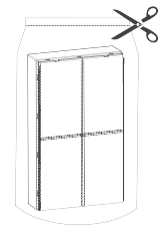
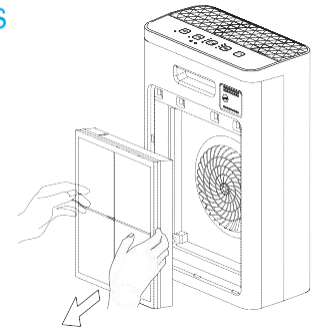

# Operation

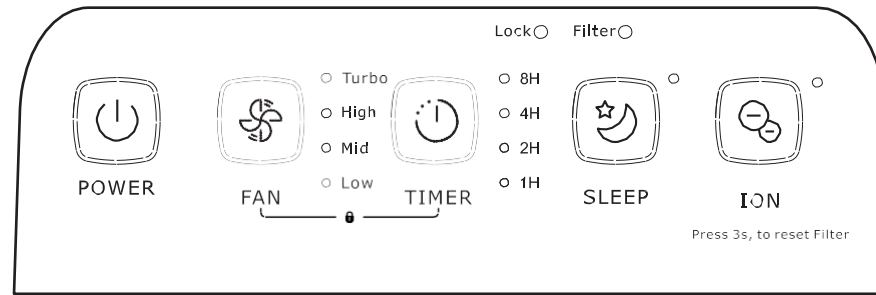

POWER

## ON/OFF button

Press "POWER" button to turn on/off the unit.



FAN

## Purification button

Press "FAN" button to choose the options of strong, high, medium and low.



TIMER

## Timer button

Press "TIMER" button, the time of timer off in turn sets as 1 hour, 2 hours, 4 hours, 8 hours and off, respectively.



SLEEP

## Sleep button

Press "SLEEP" button to turn on/off sleeping function.

For sleeping mode, the light of sleeping mode lights.



ION

## Ion button

Press "ION" button to turn on/off anion function.

## Filter

When cleaning filter light flashes it reminds you that you need to clean filters. After the cleaning, press "ION" button for 3 seconds, the timer resets from the beginning.

## Lock function:

### Lock



FAN

+



TIMER

Press "FAN" and "TIMER" buttons at the same time for one second, then turn on lock function. The "LOCK" light illuminates. There will be no reaction when press other keys. Press the buttons again, turn off lock function.

## Operation

### Place correctly

In order to achieve better purification effect and avoid affecting communication by shielding effect of metal, make sure that keep the machine 30 centimeters away from walls, furnitures and so on and at least 50 centimeters away from metals/electrical appliances.

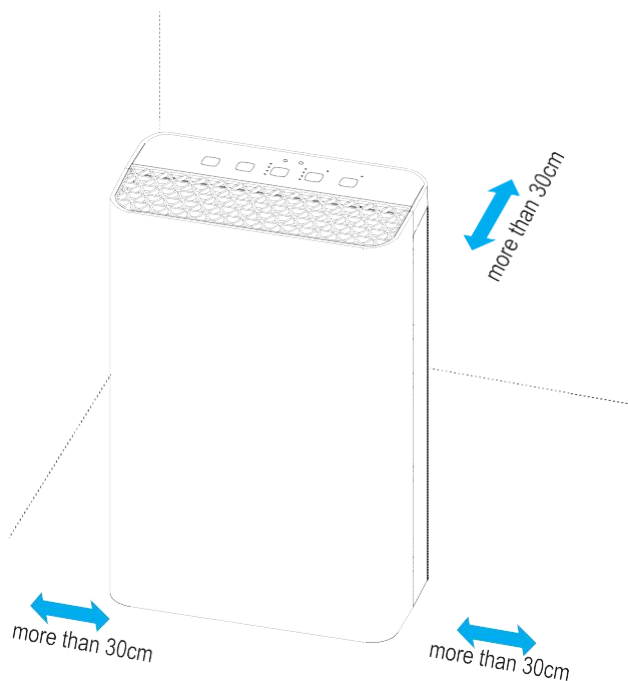

## Maintenance

### Cleaning/Replacement of filter component

#### Filter ○

Clean filter components when cleaning filter light flashes.



Clean filter with cleaners or brushes.



Recommend to replace filter components when filter components is broken or filtering effect is poor .



Install the filter components.

Read the "installation" section for details .



ION

Press "ION" button for 3 seconds, the timer resets from the beginning.

#### Tips:

Do not clean filter with water.

Recommend to clean filter with small soft brushes or household cleaners.

In the use of a strong smell of cigarettes, barbecue, etc., within a few weeks or months, the filter may produce a smell. Please clean the filter and air filter for 2-5 days. If you still can not get rid of the smell, please replace the filter.



## Faults Diagnosis

Please check the machine according to the following form before asking for maintenance:

Faults Diagnosis	Posslble Reasons	Posslble Solutions
Air purifier does not run.	<ul style="list-style-type: none"> <li>-Maybe forget to connect the power wires or the connection were not in good condition.</li> <li>-Maybe forget to press down the power switch.</li> </ul>	<ul style="list-style-type: none"> <li>-Please plug In the power well.</li> <li>-please press down the power switch.</li> </ul>
Poor effects of oil and smell removal.	<ul style="list-style-type: none"> <li>-Maybe filter components are in opposite position.</li> <li>-Maybe the lifetime of fltler components is over.</li> <li>-Maybe the air Inlet Is stuck by something.</li> </ul>	<ul style="list-style-type: none"> <li>-Please install filter components correctly.</li> <li>-Please replace new fltler components.</li> <li>-Please remove the things in air inlet.</li> </ul>
Cleaning light of filter components does not turn off.	<ul style="list-style-type: none"> <li>-Maybe does not press "ION" button for 3 seconds after cleaning filter components.</li> </ul>	<ul style="list-style-type: none"> <li>-Press "ION" button for 3 seconds after cleaning filter components.</li> </ul>
Smell and smoke Is hard to remove.	<ul style="list-style-type: none"> <li>-Maybe filter components are still in packaging bags.</li> </ul>	<ul style="list-style-type: none"> <li>-Please remove packaging bags of filter components.</li> </ul>

Please request for repair if occur the following situations:

1. Operate abnormally or does not operate, and the solutions above is useless.
2. Operate abnormally because of things or water entering inside.

## CONVENTIONAL WARRANTY

Dear Customer,

Thank you for purchasing a Diloc brand product and we are sure you will be satisfied with it.

We recommend that you carefully read and keep the use and maintenance manual present in each product.

### Conventional warranty

Hereby, Naicon srl guarantees the product from any material or manufacturing defect for a period of 24 months and covers only the spare parts. The compressor is guaranteed for 60 months.

If during the warranty period material or manufacturing defects are found, the Naicon srl affiliates, the Authorized assistance or authorized dealers will repair or (at the discretion of Naicon srl) replace the product or its defective components, in the terms and conditions indicated below, without any charge for the costs of labor or spare parts.

Naicon srl reserves the right (in its sole discretion) to replace the components of defective products or low-cost products with assembled parts or new or overhauled products.

Naicon srl does not extend this conventional warranty to UNAUTHORIZED dealers and to those products installed by unqualified personnel (e.g. without FGAS license).

### Conditions.

1. This warranty will only be valid if the defective product will be presented together with the sales invoice, sales receipt or certificate from the dealer (indicating the date of purchase, the type of product and the name of the dealer).

Naicon srl reserves the right to refuse warranty work in the absence of the aforementioned documents or in the event that the information contained therein is incomplete or illegible.

2. This warranty does not cover costs and / or any damage and / or defects resulting from modifications or adaptations made to the product, without prior written authorization issued by Naicon, in order to conform it to technical or technical standards national or local security in force in countries other than those for which the product was originally designed and manufactured.

3. This warranty will expire if the indication of the model or serial number shown on the product is been modified, canceled, removed or otherwise rendered illegible.

4. The guarantee does not include:

a. Periodic maintenance and repair or replacement of parts subject to normal wear and tear

- b. Any adaptation or modification made to the product, without prior written authorization from Naicon for enhance performance compared to those described in the use and maintenance manual;
  - c. All costs of leaving the technical staff and any transport from the customer's home to Naicon srl, or to the laboratory the Assistance Center and vice versa, as well as all related risks;
  - d. Damages resulting from:
    - Improper use, including but not limited to: (a) the use of the product for purposes other than those envisaged or failure to comply with Diloc instructions on the correct use and maintenance of the product, (b) installation or use of the product not compliant with the technical or safety standards in force in the country in which it is used;
    - Repair interventions by unauthorized personnel or by the Customer himself;
    - Incidental events, lightning, floods, fires, incorrect ventilation or other causes not attributable to Diloc;
    - Defects in the systems or equipment to which the product had been connected.
5. This warranty does not affect the rights of the buyer established by the applicable national laws in force, nor the rights of the customer towards the retailer deriving from the sales contract.

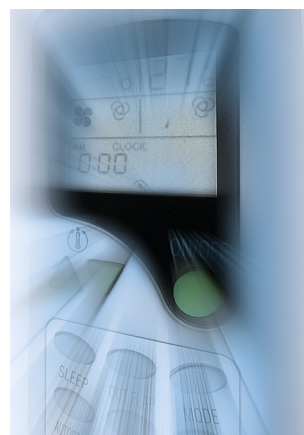

Naicon SRL - Via il Caravaggio, 25 - Trecella  
I-20060 Pozzuolo Martesana - Milano (Italy)  
Tel. +39 02.95.003.1 Fax +39 02.95.003.313  
[www.naicon.com](http://www.naicon.com) - e-mail: [naicon@naicon.com](mailto:naicon@naicon.com)

